



**QMS REGISTERED TO ISO 9001**

# **HAND ROLLER CATALOG FOR TIRE AND RUBBER WORKING INDUSTRIES**

**EVERHARD PRODUCTS, INC.**

1016 Ninth Street SW ■ Canton, Ohio 44707 USA

Toll-free: 1-800-298-2832 or 330-453-7786

Toll-free Fax: 1-800-225-0984 or 330-453-7449

**[Tire.Everhard.com](http://Tire.Everhard.com)**

Rollers and stitchers are arranged in order of smallest to largest diameter.

### SMOOTH SURFACE STITCHERS



MODEL #	DIA.	WIDTH	ADDITIONAL INFORMATION
MR01480	1"	1/2"	
MR01000	1-1/8"	1/32"	SA1
MR01010	1-1/8"	1/16"	SA2
MR01020	1-1/8"	1/8"	SA3
MR01030	1-1/8"	1/4"	SA4
MR01040	1-1/4"	1/32"	SB1
MR01050	1-1/4"	1/16"	SB2
MR01060	1-1/4"	1/8"	SB3
MR01070	1-1/4"	1/4"	SB4
MR01090	1-1/2"	1/16"	SC2; Ergonomic model MR01095
MR01100	1-1/2"	1/8"	SC3
MR01110	1-1/2"	1/4"	SC4; Ergonomic model MR01111
MR01240	1-1/2"	5/8"	102
MR01250	1-1/2"	3/4"	103
MR01340	1-1/2"	1/2"	112
MR01120	2"	1/32"	SD1
MR01130	2"	1/16"	SD2
MR01140	2"	1/8"	SD3; Ergonomic model MR01141
MR01150	2"	1/4"	SD4; Ergonomic model MR01151
MR01260	2"	3/4"	104
MR01280	2"	1/2"	106
MR01460	2"	3/8"	
MR01370	2"	1/4"	180; w/10" handle
MR01170	2-1/2"	1/16"	SE2

### SMOOTH SURFACE STITCHERS (cont'd.)

MODEL #	DIA.	WIDTH	ADDITIONAL INFORMATION
MR01180	2-1/2"	1/8"	SE3
MR01190	2-1/2"	1/4"	SE4
MR01320	2-1/2"	3/16"	
MR01210	3"	1/16"	SF2
MR01220	3"	1/8"	SF3
MR01230	3"	1/4"	SF4

### SMOOTH SURFACE ROLLERS



MODEL #	DIA.	WIDTH	ADDITIONAL INFORMATION
MR02000	1"	1"	FR-1
MR02010	1"	1-1/2"	FR-2
MR02120	1"	2"	117
MR02060	1-3/8"	3-1/2"	100G, w/safety guard
MR02020	1-1/2"	1-1/2"	FR-3
MR02030	1-1/2"	2"	FR-4
MR02310	1-1/2"	1-1/2"	FR3-HB, Heavy duty bearings
MR02070	1-5/8"	3-1/2"	101G, w/safety guard
MR02340	2"	1"	
MR02040	2"	2"	FR-5
MR02050	2"	2-1/2"	FR-6
MR02080	2"	3"	113
MR02100	2"	4"	115
MR02110	2"	6"	116
MR02140	2"	2"	201
MR02440	2"	2-1/2"	FR6-HB, Heavy duty bearings

Rollers and stitchers are arranged in order of smallest to largest diameter.

### SMOOTH BEVELED ROLLERS/STITCHERS



MODEL #	LD	SD	WIDTH	ADDITIONAL INFO
MR09500	2"	1-1/2"	1/2"	BA1
MR09510	2"	1-1/2"	9/16"	BA2
MR09520	2"	2"	1/2"	BB1
MR10010	2"	1-1/2"	2"	148
MR09570	2-1/4"	1-17/32"	1/4"	S2
MR10000	2-3/8"	1-3/8"	1-1/8"	136
MR09530	2-1/2"	2"	9/16"	BB2
MR09540	2-1/2"	1-1/2"	1/2"	BC1
MR09550	2-1/2"	1-1/2"	3/4"	BC2
MR09560	2-1/2"	1-1/2"	1/2"	BD3

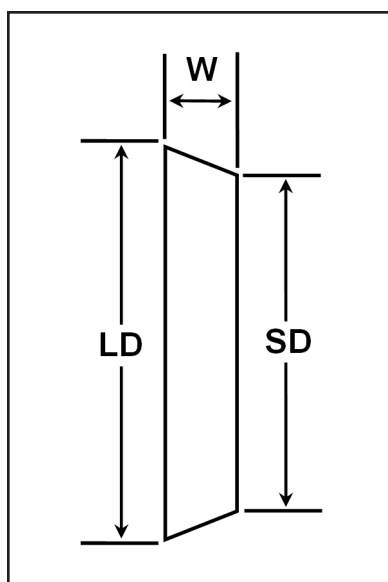

Beveled roller/stitcher diagram

### CORRUGATED BEVEL STITCHERS



MODEL #	LD	SD	WIDTH	ADDITIONAL INFO
MR10270	2"	1-1/2"	1/2"	T2, 96 teeth
MR10280	2"	1-1/2"	9/16"	T3, 96 teeth
MR10290	2"	1-1/2"	9/16"	T4, 48 teeth
MR10260	2"	1-3/4"	1/4"	T1
MR10310	2"	1-3/4"	1/4"	242; diamond knurl
MR10320	2"	1-3/4"	35/64"	Bevel-toothed stitcher
MR04280	2"	1-1/2"	9/16"	Knurled surface; insulated handle (no metal collar)

### BUTT SPLICERS



MODEL #	DESCRIPTION
MR13120	Butt Splicer, two 1-3/4" dia x 1/8" wide corrugated wheels at 48° included angle to each other - 1/16" gap between wheel edges at closest point
MR13130	Butt Splicer, two 2" dia x 7/16" wide bevel gear wheels at 52° included angle to each other - Gear teeth mesh loosely
MR13150	Butt Splicer, four 15/16" dia x 3/64" wide corrugated wheels per side, rotating independently at a 30° included angle to each other - 3/64" gap between wheel edges at closest point

Rollers and stitchers are arranged in order of smallest to largest diameter.

### CORRUGATED STITCHERS

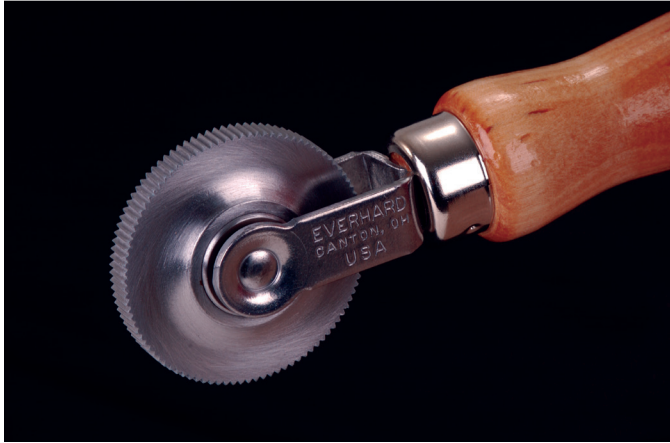

MODEL #	DIA.	WIDTH	ADDITIONAL INFORMATION
MR02760	1-1/8"	1/32"	CA-1 CORR ROLLER 1.125 X .031
MR02770	1-1/8"	1/16"	CA-2 CORR ROLLER 1.125 X .063
MR02780	1-1/8"	1/8"	CA-3 CORR ROLLER 1.125 X .125
MR02790	1-1/8"	1/4"	CA-4 CORR ROLLER 1.125 X .25
MR02810	1-1/4"	1/16"	CB-2 CORR ROLLER 1.25 X .063
MR02820	1-1/4"	1/8"	CB-3 CORR ROLLER 1.25 X .125
MR02830	1-1/4"	1/4"	CB-4 CORR ROLLER 1.25 X .25
MR02840	1-1/2"	1/32"	CC1 CORR ROLLER 1.5 X .031
MR02850	1-1/2"	1/16"	CC2 CORR ROLLER 1.5 X .063 **
MR02860	1-1/2"	1/8"	CC3 CORR ROLLER 1.5 X .125
MR02870	1-1/2"	1/4"	CC4 CORR ROLLER 1.5 X .25
MR02960	1-3/4"	1/16"	127 CORR ROLLER 1.75 X .063
MR02970	1-3/4"	1/8"	128 CORR ROLLER 1.75 X .125
MR02980	1-3/4"	1/4"	129 CORR ROLLER 1.75 X .25
MR02880	2"	1/32"	CD1 CORR ROLLER 2 X .031
MR02890	2"	1/16"	CD2 CORRUGATED ROLLER 2 X .063
MR02900	2"	1/8"	CD3 CORR ROLLER 2 X .125
MR02910	2"	1/4"	CD4 CORRUGATED ROLLER 2 X .25
MR02930	2"	3/4"	123 CORRUGATED ROLLER 2 X .75
MR02940	2"	3/4"	124 CORRUGATED ROLLER 2 X .75
MR02950	2"	1/2"	126 CORRUGATED ROLLER 2 X .5
MR02990	2"	3/8"	139 CORRUGATED ROLLER 2 X .375

### CORRUGATED ROLLERS

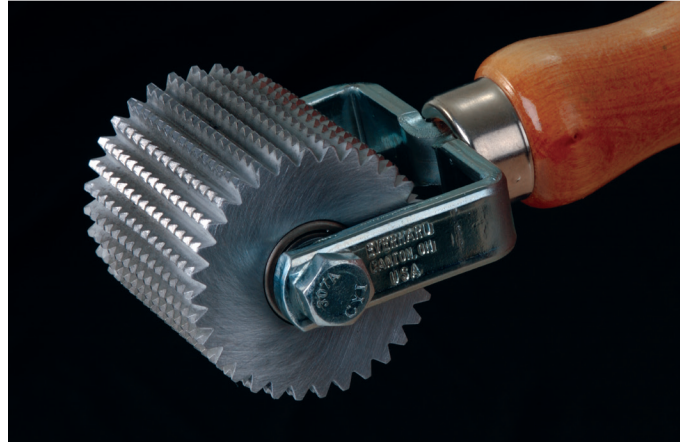

MODEL #	DIA.	WIDTH	ADDITIONAL INFORMATION
MR03040	1-1/2"	1/2"	227 CORR ROLLER
MR03110	1-1/2"	1/8"	CC3F CORR ROLLER
MR03770	1-1/2"	1-1/2"	219 CORR ROLLER
MR03830	1-3/4"	3/4"	373 DOUBLE TRACK CORR ROLLER
MR03030	2"	1/4"	197 CORR ROLLER
MR03080	2"	1/4"	269 CORR ROLLER W/10" HANDLE
MR03760	2"	2-1/8"	125 CORR ROLLER
MR03790	2"	2-1/8"	216 W/10" HANDLE, W/GUARD
MR03150	2-1/2"	1/4"	218 CORR ROLLER

Rollers and stitchers are arranged in order of smallest to largest diameter.

### CONCAVE BEVEL STITCHERS



MODEL #	LD	SD	WIDTH	RADIUS	ADDL INFO
MR07060	1-1/2"	1-1/8"	1/4"	3/16"	159
MR07140	2"	1-11/16"	5/32"	1/8"	K8A
MR07150	2"	1-7/8"	3/32"	1/16"	WA1
MR07000	2-1/2"	1-1/2"	9/16"	7/16"	R1
MR07020	2-1/2"	2"	1/2"	5/8"	R3
MR07030	2-1/2"	1-1/2"	3/4"	5/8"	R4
MR07040	2-1/2"	1-1/2"	9/16"	7/16"	142 (notched)
MR07130	2-1/2"	2"	3/4"	9/16"	310
MR07010	3"	1-1/2"	3/4"	5/8"	R2
MR07120	3"	1-1/2"	11/16"	11/16"	179

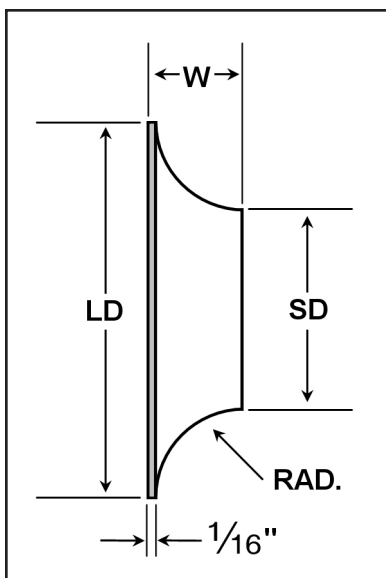

Concave bevel stitcher diagram

### WIDE CONCAVE ROLLERS



MODEL #	ED	MD	W	RADIUS	ADDL INFO
MR08050	1-5/16"	1"	3"	7-9/32"	1138
MR08000	1-1/2"	1-1/8"	2"	3"	D1
MR08030	1-1/2"	15/16"	2-1/2"	2-3/4"	135
MR08010	2"	1-5/8"	2"	2-3/4"	D2
MR08020	2"	1-5/8"	2-1/2"	4-1/4"	D3

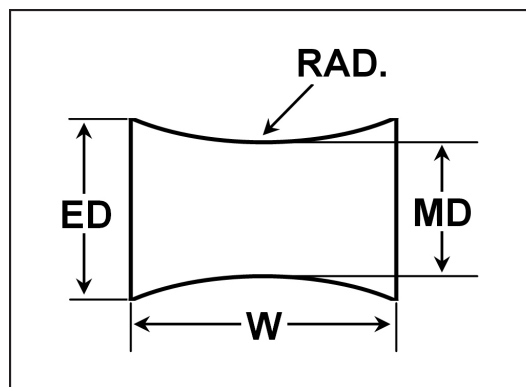

Wide concave roller diagram



Rollers and stitchers are arranged in order of smallest to largest diameter.

### PORCUPINE ROLLERS



MODEL #	DIA.	WIDTH	ADDITIONAL INFORMATION
MR05650	1-11/16"	11/32"	PR-3G, W/GUARD
MR05500	1-3/4"	1/4"	PR-2
MR05510	1-3/4"	1/4"	PR-2G, W/GUARD
MR05550	1-3/4"	1/2"	133
MR05555	1-3/4"	1/2"	133G, W/GUARD
MR05515	1-7/8"	3/4"	130
MR05520	1-7/8"	3/4"	130G, W/GUARD
MR05540	2"	3/4"	132
MR05545	2"	3/4"	132G, W/GUARD
MR05570	2"	1/4"	153G, W/GUARD
MR05590	2"	1/4"	256
MR06500	2"	2"	PR-1
MR06510	2"	2"	PR-1G, W/GUARD
MR05535	2-1/4"	5/8"	131G, W/GUARD
MR05655	2-1/4"	1/4"	PR10
MR05660	2-1/4"	1/4"	PR-10G, W/GUARD
MR05580	3"	3/4"	223G, W/10" HANDLE, W/GUARD

### RUBBER ROLLERS



MODEL#	DIA.	WIDTH	HARDNESS	ADDITIONAL INFO
MR05020	1-7/16"	1-3/4"	60	150 SILICONE
MR04780	1-1/2"	1/2"	50	291 URETHANE
MR05070	1-1/2"	1-1/2"	60	254 URETHANE
MR04760	2"	1/2"	80	164 URETHANE
MR04800	2"	1"	40	276 URETHANE
MR05000	2"	2"	60-65	RR-1 RUBBER
MR05010	2"	2-1/4"	60-65	RR-2 RUBBER
MR05050	2"	2"	30	233 URETHANE
MR05060	2"	4"	60	246 URETHANE
MR05080	2"	2"	40-44	257 URETHANE
MR05090	2"	2-1/2"	42	258 URETHANE
MR05091	2"	2-1/2"	42	URETHANE, 10" HANDLE
MR05110	2"	4"	60	SILICONE
MR05130	2"	1"	60-65	RUBBER
MR05160	2"	2"	40-44	WHITE URETHANE
MR05240	2"	2"	45-50	SILICONE
MR04770	2-1/4"	.30"	70	274 URETHANE

Rollers and stitchers are arranged in order of smallest to largest diameter.

### ROUNDED-EDGE ROLLERS



MODEL #	DIA.	WIDTH	RADIUS	ADDITIONAL INFO
MR08620	1-1/4"	1/16"	1/32"	183
MR08570	1-1/2"	1/16"	1/32"	177
MR09260	1-5/8"	2"	2-3/4"	268
MR08500	2"	1/16"	1/32"	S1
MR08580	2"	1/4"	1/8"	187
MR08590	2-1/4"	1/2"	1/4"	198
MR08510	2-1/2"	1/16"	1/32"	S5
MR08520	2-1/2"	3/32"	3/64"	S6
MR08530	2-1/2"	1/8"	1/16"	S7
MR08540	2-1/2"	1/64"	1/64"	S8
MR08550	2-1/2"	3/16"	3/32"	S9
MR08560	3"	1/16"	1/32"	S10

### ROTARY TRIMMERS



MODEL #	DESCRIPTION
MR11280	ROTARY TRIM DOUBLE BEVEL, 2-1/2" DIA. (J2D)
MR11284	MR11280 with EF SGPH

### GOOSENECK STITCHERS



MODEL #	DIA.	WIDTH	EDGE	ADDITIONAL INFO
MR10770	1-1/8"	1/16"	Smooth	119S curved fork
MR10775	1-1/8"	1/16"	Corrugated	119C curved fork
MR10780	1-1/8"	1/8"	Smooth	120S curved fork
MR10785	1-1/8"	1/8"	Corrugated	120C curved fork
MR10795	1-1/8"	1/4"	Corrugated	121C curved fork
MR10940	3/4"	1/16"	Smooth	2-9/16" extended fork
MR10950	3/4"	1/8"	Smooth	2-9/16" extended fork
MR10960	3/4"	1/4"	Smooth	2-9/16" extended fork
MR10900	1"	1/16"	Smooth	2-9/16" extended fork
MR10910	1"	1/16"	Corrugated	2-9/16" extended fork
MR10920	1"	1/8"	Smooth	2-9/16" extended fork
MR10930	1"	1/4"	Smooth	2-9/16" extended fork
MR10980	1"	1/8"	Corrugated	2-9/16" extended fork
MR10840	3/4"	1/16"	Smooth	4-3/16" extended fork
MR10850	3/4"	1/8"	Smooth	4-3/16" extended fork
MR10860	3/4"	1/4"	Smooth	4-3/16" extended fork
MR10800	1"	1/16"	Smooth	4-3/16" extended fork
MR10810	1"	1/16"	Corrugated	4-3/16" extended fork
MR10820	1"	1/8"	Smooth	4-3/16" extended fork
MR10830	1"	1/4"	Smooth	4-3/16" extended fork
MR10880	1"	1/8"	Corrugated	4-3/16" extended fork

#### OPTIONS:

- 1 - SGPH (soft grip plastic handle).
- 2 - EF SGPH (soft grip plastic handle with ergonomic fork).
- 3 - PH (plastic handle only).
- 4 - 10" wood handle.

Rollers and stitchers with options require a 6-piece minimum order.